

Log In when working in another Former Region

Acronym List.....	ii
Review History	ii
Version History.....	ii
Sign on to SHA Computer NOT in HOME Region	1
1. Log in to laptop.....	1
2. Former Region Table.....	1

Acronym List

eHS eHealth Saskatchewan
 SHA Saskatchewan Health Authority

Review History

Reviewed by	Review Date	Reason
<i>KM TL - Jewsbury</i>	<i>March 22, 2021</i>	<i>Create for Vaccine Clinic Readiness</i>
<i>KM TL – Jewsbury</i>	<i>April 9, 2021</i>	<i>Check bookmark</i>

Version History

Version	Implemented by	Revision Date	Approval	Reason
<i>1.0</i>	<i>KBA - Zwirsky</i>	<i>March 22, 2021</i>	<i>KM TL - Jewsbury</i>	<i>Create for Vaccine Clinic Readiness</i>
<i>1.1</i>	<i>KM TL - Jewsbury</i>	<i>March 22, 2021</i>		<i>Formatting</i>
<i>1.2</i>	<i>KBA – Neudorf</i>	<i>April 8, 2021</i>		<i>Formatting</i>

Sign on to SHA Computer NOT in HOME Region

1. Log in to laptop

Requirement: The computer must be connected to SHA Network (CNET).

a. Log in to device using the following format:

Username: DOMAIN\Username

(Refer to **Former Region Table** below if you are uncertain of DOMAIN name)

Password: Your existing network password

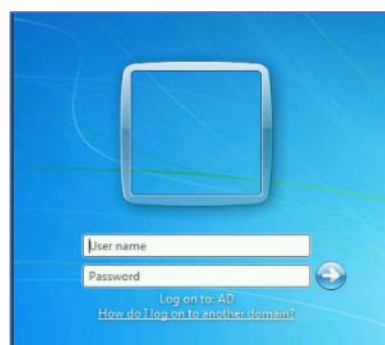
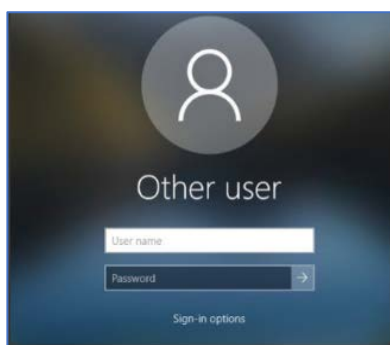

2. Former Region Table

Former Region	Domain	Example Login
Cypress (Swift Current)	CHR	CHR\jsmith
Five Hills (Moose Jaw)	FHHR	FHHR\jsmith
Heartland (Outlook, Kindersley, Rosetown)	HRHA	HRHA\jsmith
Keewatin Yatthe (LaLoche)	KYRHA	KYRHA\jsmith
Kelsey Trail (Melfort, Tisdale)	KTHR	KTHR\jsmith
Mamawetan Churchill (La Ronge)	HEALTH	HEALTH\jsmith
Prairie North (North Battleford, Lloydminster)	PNRHA	PNRHA\jsmith
Prince Albert (Prince Albert, Spiritwood)	PAPHR	PAPHR\jsmith
Regina Qu'Appelle (Regina)	RQHealth	RQHealth\smithjohn
Saskatoon (Saskatoon)	SKTNHR	SKTNHR\smithj
SKHealth Domain	SKHEALTH	SKHEALTH\jsmith
Sun Country (Weyburn, Estevan)	NTSCHD	NTSCHD\jsmith
Sunrise (Yorkton)	SHR	SHR\jsmith

NOTE: If you are unsure of your username or password please contact the **eHealth Service Desk** at **1-888-316-7446**.