

Overview

MySaskHealthRecord is a secure website that enables eligible Saskatchewan citizens 14 years of age and older to quickly and easily access their personal health information. Those who sign up will be able to access their personal health information, including laboratory test results (includes COVID-19 test results), medical imaging reports, prescription and immunization history (includes COVID-19 vaccinations), and clinical visit history (displayed as inpatient, outpatient or emergency visits to a health care facility). All personal health information in MySaskHealthRecord is stored securely, and can only be accessed through a highly secure, personalized login.

Each patient will have the ability to collect and track health information from a variety of data sources in their MySaskHealthRecord account. Each data source type will display as a distinct colour to differentiate the information sources. The three data source types are:

- **Provincial Health Data (Green)** – Clinical data as collected from facilities with information systems that share data to the provincial repository. This includes data for clinical visit history, laboratory test results, medical imaging reports, immunization history, prescription history, and clinical documents.
- **Device Entered Data (Orange)** – Patients can connect their personal health and fitness applications or devices, such as an activity tracker or blood glucose monitor, to sync and upload data into their MySaskHealthRecord.
- **Self-Entered Data (Yellow)** – Patients can manually enter in their own personal health information such as allergies, surgical history, emergency contacts, etc. for their own tracking purposes.

A disclaimer is displayed throughout indicating that the health information in MySaskHealthRecord is for patients' information only, and should not be interpreted as medical advice or used for self-diagnosis.

Information within MySaskHealthRecord

MySaskHealthRecord Homepage

The MySaskHealthRecord homepage provides patients with a quick overview of their health history. It includes a snapshot of patients' recently added provincial health data, a subscription option for when new data is available, and quick links for key clinical data domains.

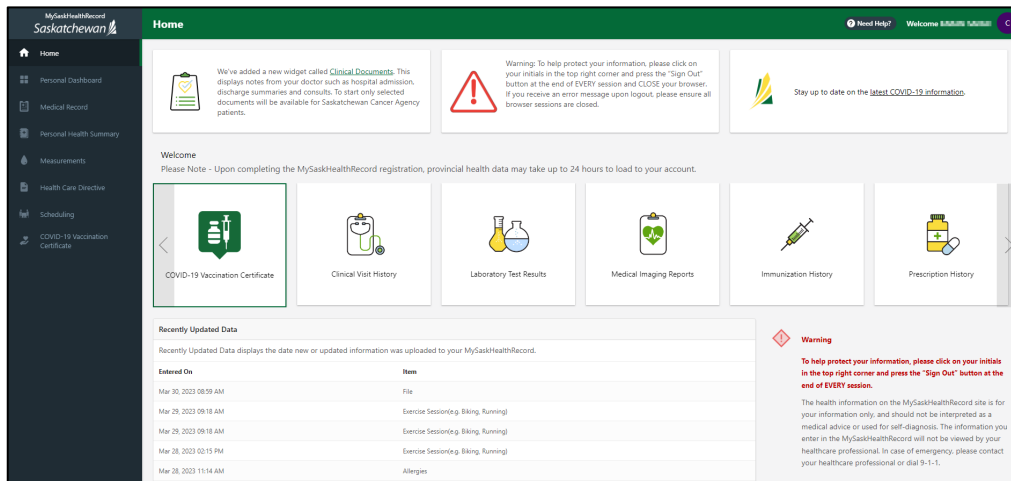

Personal Dashboard

The personal dashboard provides patients with an overview of the health information most important to them. They can customize their dashboard to choose what information they would like it to display. This information is saved on their personal dashboard unless they wish to further customize.

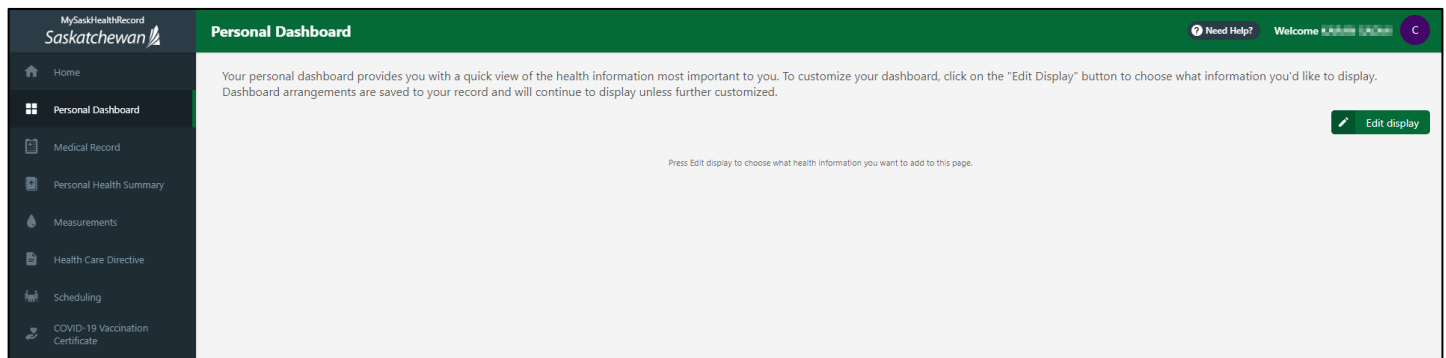

Medical Record

The medical record section provides clinical information sourced by the provincial repositories as well as data entered by patients themselves.

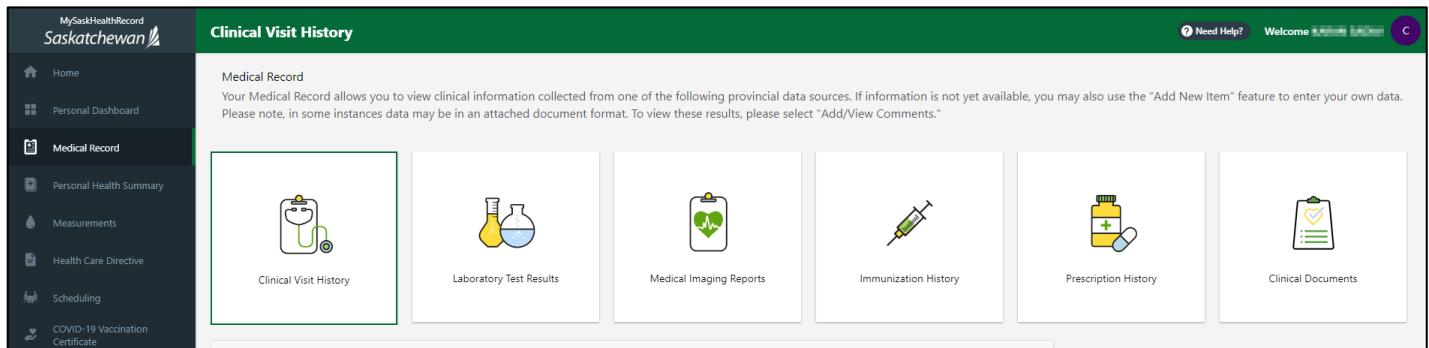

Information regarding the five primary data domains in MySaskHealthRecord are as follows:

- Clinical Visit History**

Clinical visit information as provided by the registration systems (e.g. WinCIS, SER, etc.) used in health care facilities, with the majority being acute care facilities and hospitals. The clinical visits displayed include visits related to inpatient, outpatient, or emergency services, and include the attending providers' name if available. Providers' notes regarding these visits will not be available, but patients are able to enter comments manually. An example of the information displayed in MySaskHealthRecord is pictured below:

Clinical Visit History

Clinical visit information is provided by the registration systems that are used in health care facilities, with the majority being acute care facilities and hospitals. The clinical visits displayed can include visits related to inpatient, outpatient or emergency services.

Data Source

☒ Provincial ☐ Self-Entered

Date Range

All

[Add New Item](#)

Registration Type	Location	Provider	Admission Date	Discharge Date	Status	Comments
Inpatient	Yorkton Regional Health Centre		2019-06-04 2:39 PM		In Progress	Add Comment View Comments
Outpatient	Victoria Hospital		2019-06-04 2:32 PM		Finished	Add Comment View Comments
Emergency	Lloydminster Hospital		2019-05-31 3:29 PM	2019-05-31 5:08 PM	Finished	Add Comment View Comments

- Laboratory Test Results**

Finalized and/or amended general laboratory, blood bank, microbiology, and pathology information will be available as collected from Saskatchewan Health Authority laboratories and the Roy Romanow Provincial Lab. Results are displayed based on their collection from the source systems, including any reference ranges or notes, and may be in a PDF or attached document format. **NOTE:** All pathology results will have a 4-day delay to MySaskHealthRecord users from the time the pathology results are available electronically to providers. An example of the information displayed in MySaskHealthRecord is pictured below:

Laboratory Test Results

Laboratory results are provided by the Saskatchewan Health Authority lab information systems. The results displayed include general tests ordered by your health care provider.

Data Source

Provincial

Self-Entered

Date Range

All

Add New Item

Date

2016-01-06 3:18 PM

Ordered by

STEWART, ROD

Add Comment

View Comments/Documents

Ferritin

Test Name	Test Result	Reference Range	Notes
Ferritin	10,000 ug/L	10-200	

Date

2017-10-19 6:00 AM

Ordered by

LENNON, JOHN

Add Comment

View Comments/Documents

Urine; Culture

- Medical Imaging Reports**

Finalized and/or amended diagnostic reports as collected from the Saskatchewan Health Authority and select private radiology organizations. Medical imaging reports will be displayed as collected from the source systems in an attached document format, and do not include images. An example of the information displayed in MySaskHealthRecord is pictured below:

Medical Imaging Reports

Medical Imaging reports are provided by the diagnostic imaging systems that are used in hospitals, primary care centers and private diagnostic imaging facilities.

Data Source

☒ Provincial ☐ Self-Entered

Date Range

All

[Add New Item](#)

Date	Provider	Exam Type	Comments/Related Info
2019-05-31 8:38 PM	[Redacted]	DX Abdomen 1 View	Add Comment View Related Items

- Immunization History**

Immunization history will provide a full history of data for patients sourced from the Saskatchewan immunization registry, Panorama. The data will only be information available in Panorama, and not from physician offices or other clinics that do not input data into Panorama. An example of the information displayed in MySaskHealthRecord is pictured below:

Immunization History

This record contains immunizations (also called vaccines) as recorded in Panorama, the Saskatchewan Immunization Registry. It may not list all vaccines ever received in a person's lifetime. For example, immunizations received at a doctor's office, emergency room or private travel clinic (anywhere not delivered by public health) may or may not be listed. If you have questions or concerns about your immunization record or for general immunization information, please contact your local public health office.

Data Source

☒ Provincial ☐ Self-Entered

[Add New Item](#)

Date	Vaccine	Provider	Location	Comments
1968-08-18	Diphtheria (d), Pertussis (ap), Tetanus (T)		Regina Central Public Health Office	Add Comment View Comments

1 2

- Prescription History**

Prescription history contains medications from the Saskatchewan's Pharmaceutical Information Program (PIP) as recorded in community pharmacies in the province. It may not list all medications ever received in a person's lifetime. For example, medications received at some health care facilities, doctors' offices, hospitals, cancer clinics, etc. may not display in MySaskHealthRecord. An example of the information displayed in MySaskHealthRecord is pictured below:

Prescription History

Prescription History allows you to enter and monitor your medications.

This record contains medications from the Saskatchewan's Pharmaceutical Information Program (PIP) as recorded in community pharmacies across Saskatchewan. It may not list all medications ever received in a person's lifetime. For example, medications received at some health care facilities, doctor's office, hospital, cancer clinic, etc. may not display in MySaskHealthRecord. If you have questions or concerns about your medication records, please contact your pharmacy.

For general questions, please refer to the FAQ document [here](#).

Data Source
☒ Provincial ☐ Self-Entered

Add New Item

Refill Info	Medication Name	Prescribed By	Prescription Quantity	Date Prescribed	Refills Left	Instructions	Comments
✓	TARO-WARFARIN 4 MG TABLET			2019-12-03	140	TAKE 1 TABLET ONCE A DAY	Add Comment View Comments
✓	Magnesium 100 Mg			2019-12-03	280	TAKE 1 TABLET TWICE DAILY	Add Comment View Comments

- Clinical Documents**

Clinical document information is provided by various source systems throughout the province. The clinical documents displayed are dictated, finalized reports of a service provided. It may not list all clinical documents ever in a person's lifetime. An example of the information displayed in MySaskHealthRecord is pictured below:

Clinical Documents							
Clinical document information is provided by various source systems throughout the province. The clinical documents displayed are dictated, finalized reports of a service provided.							
Data source							
Provincial Self-entered							
Date Range							
All							
Date	Provider	Report Type	Category	Status	Source	Action	Comments
Mar 2, 2023		SCA Discharge from SCA	DISCHARGE & TRANSFER	Final	Provincial	View Download	Add/View Comments

Please Note:

- Patients cannot delete or modify any of the provincially sourced information. They can, however, modify or delete information that was self-entered or uploaded from a device. A “Report an Error” link is available on every page that contains provincially sourced information. In the event a patient believes their health information is either incorrect or does not belong to them, they can report the issue using the online submission form at eHealthSask.ca. Once submitted, the MySaskHealthRecord support team will investigate the issue and work with the appropriate source system teams. All reported incidents will be documented for auditing purposes.
- Any corrections or updates to the patient information or results from the source systems will lead to a corresponding correction or update of information in MySaskHealthRecord.

Personal Health Summary

The personal health summary section allows patients to manually enter their data in any of the following sections:

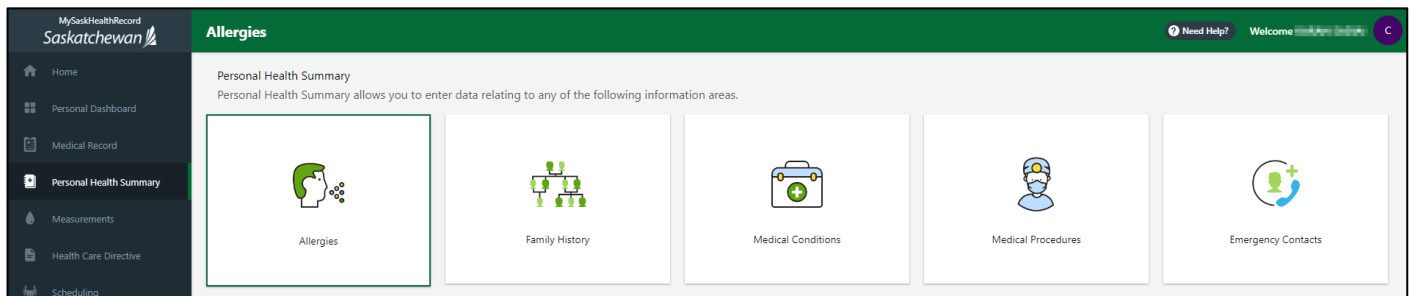

- **Allergies** – Patients can document and track allergies and intolerances affecting their personal health
- **Family History** – Patients can enter family history and medical conditions
- **Medical Conditions** – Patients can enter diagnosed conditions and current prepared treatment plans
- **Medical Procedures** – Patients can track completed medical procedures and surgical history
- **Emergency Contacts** – Patients can record and maintain a list of emergency contacts

Measurements

Patients can manually enter and track data within the measurement section of MySaskHealthRecord. For measurements collected through personal health or fitness devices, patients can upload their data using the “Connect My Device” feature.

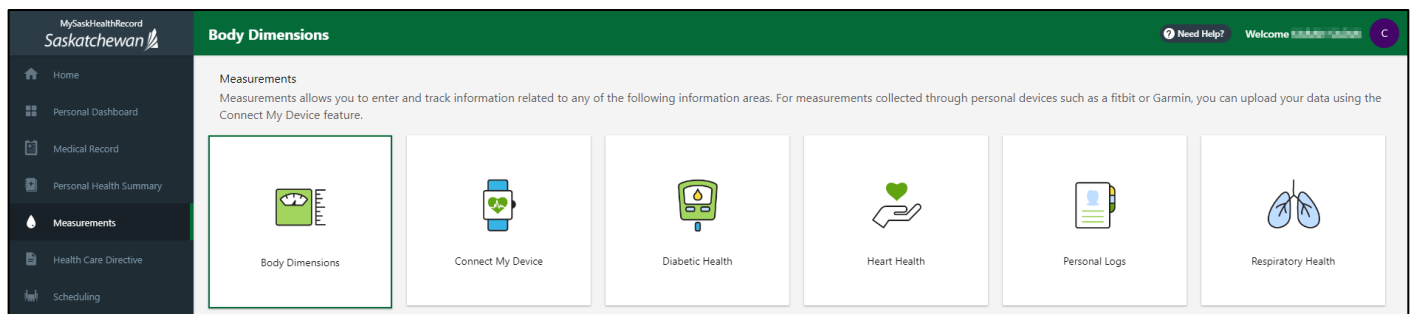

- **Body Dimensions (Height, Weight, BMI)** – Patients can monitor and keep their BMI levels in check by entering their height and weight measurements
- **Diabetic Health (Blood Glucose, HbA1C)** – Patients can enter their blood pressure and blood glucose to ensure they are within their target range
- **Heart Health (Cholesterol, Blood Pressure)** – Patients can track their blood pressure, pulse and cholesterol to monitor their cardiac health
- **Personal Logs (Exercise, Dietary, Sleep)** – Patients can track their exercise, diet, and sleep patterns for a complete health record
- **Respiratory Health (Asthma, Peak Flow Measurements)** – Patients can list their asthma inhaler medications, log inhaler use, enter blood oxygen saturation values and document peak flow measurements

Health Care Directive

The Health Care Directive area allows patients to upload completed directives in a portable document format (PDF). By uploading, the document does not automatically get added to the patient's provincial electronic health record, but is intended to allow users to keep an electronic copy with them at all times.

Scheduling

The scheduling section of MySaskHealthRecord allows patients to enter their upcoming appointments and list their health care providers.

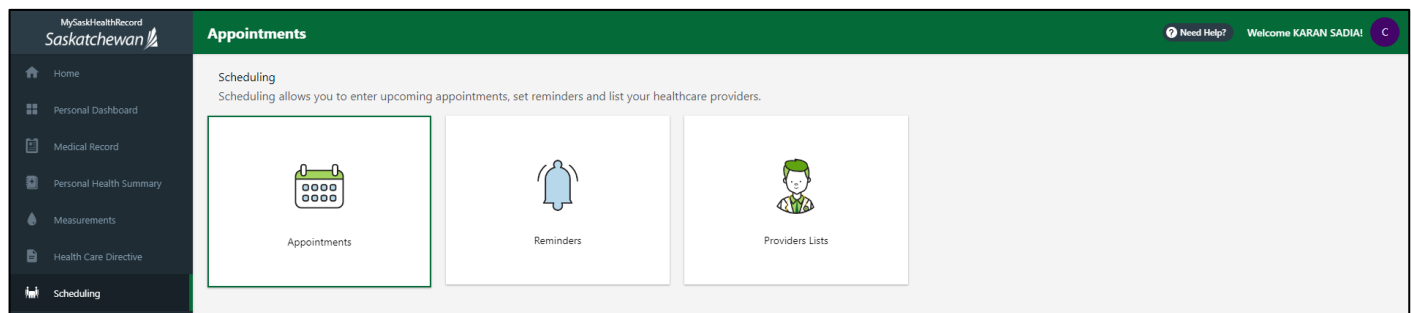

- **Appointments** – Patients can track upcoming appointments or past appointments including the reason for the appointment and set a reminder
- **Reminders** – Patients can set individual or recurring email reminders to stay on top of their medications, etc.
- **Provider Lists** – Patients can record and maintain a list of their health care providers

Please Note:

- All patient-entered health information such as allergies, medical conditions, appointment reminders, information uploaded from health devices, etc. will remain in MySaskHealthRecord and will not be shared with other health information systems.
- MySaskHealthRecord provides the ability for parents and guardians to access their dependent's health information for children under the age of 14.
 - Parents and guardians can phone the MySaskHealthRecord Service Desk at 1-844-7678259 to sign up for access to their dependent's MySaskHealthRecord information.
- Patients have the option to share their MySaskHealthRecord information with other MySaskHealthRecord users by using the "Share Record" feature. The patient controls this and they can choose to provide read, read/write, or remove access at any time.

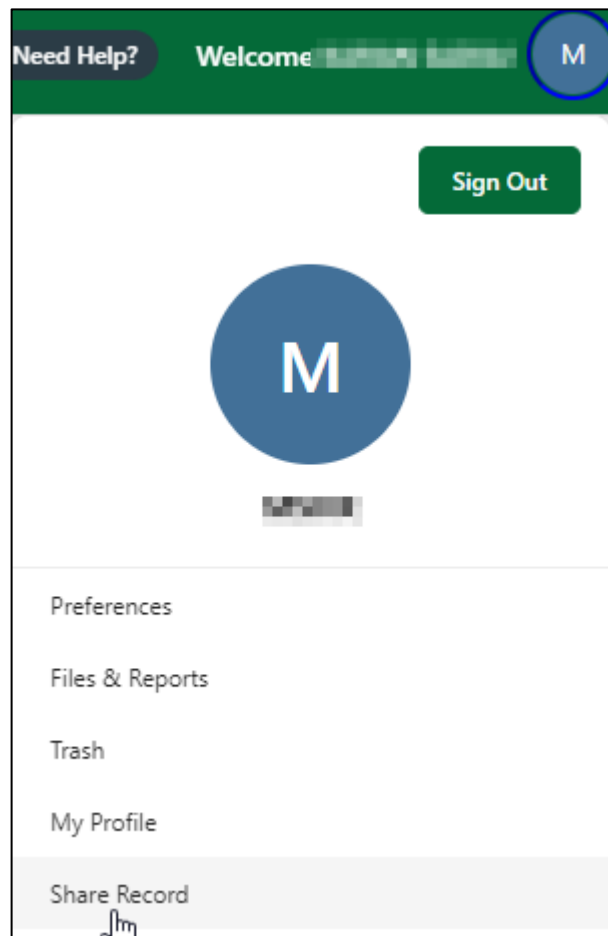

How to Register for MySaskHealthRecord

Visit eHealth Saskatchewan's website, eHealthSask.ca, and select the "MySaskHealthRecord" tab at the top of the page to begin registration.

MySaskHealthRecord Support

Health care providers and patients can use any of the following support channels:

- eHealth Saskatchewan's website, eHealthSask.ca, for more information on MySaskHealthRecord
- Providers can access provider specific support tools from the Health Care Providers section
- Message the online assistant on the MySaskHealthRecord page on eHealthSask.ca
- Call the Service Desk at 1-844-767-8259

- eHealth's Privacy Service at 1-855-eHS-LINK (347-5465) or PrivacyandAccess@eHealthSask.ca

If you would like to provide feedback or suggest additions and improvements, please visit the Contact Us page at eHealthSask.ca and fill out the [Online Support Form](#) (Select the "General Feedback" option under the "Reason" drop-down menu).